

FLORIAN

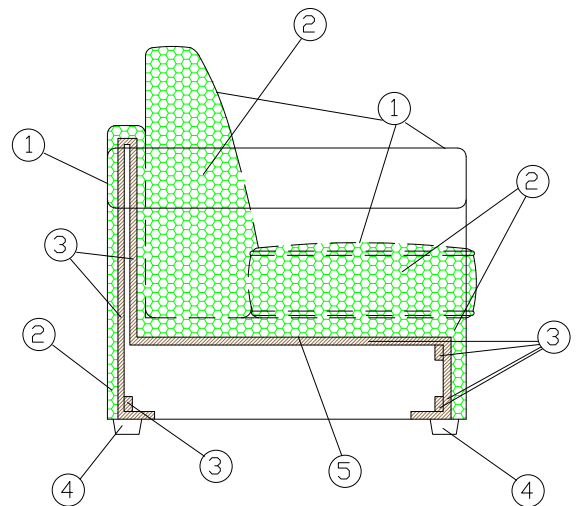

- 1 - dacron® fiber 100 gr;
- 2 - high resiliency polyurethane foam of different densities;
- 3 - structural frame in composite wood and solid poplar and pine;
- 4 - ABS feet;
- 5 - elastic webbing.



DIMENSIONS:

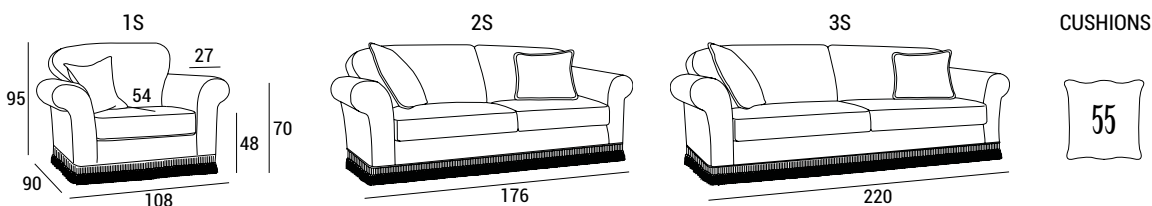

EXTRA BED:

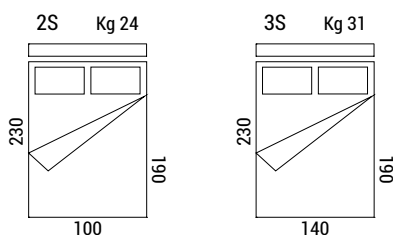

Fire retardant or standard polyurethane mattress, with two-fold mechanism, h 12 cm, covered with antiallergic polyester lining. High-resistance steel electrowelded mechanism

FLORIAN

MECHANISM BED SOFA:

Opening



REMOVE
cable ties on the sides before
lifting the sleeping deck

Opening folding the bed
incorrectly could damage
the mechanism

Closing

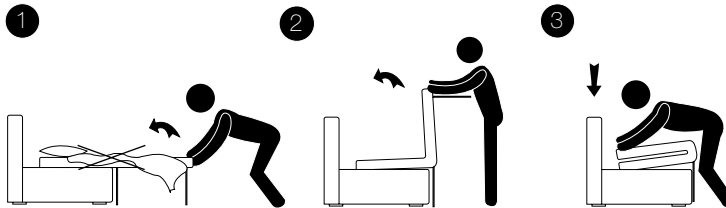

REMOVE
all sheet, blankets and pillows
before folding the sofa back
up to avoid breaking the
mechanism

FLORIAN VERSIONS:

fringe



flounce



MATCHING TRIMMINGS:

FANCY STANDARD



FANCY 1 OPTIONAL



FANCY 2 OPTIONAL



FANCY 3 OPTIONAL



FLORIAN

FANCY 4 OPTIONAL



TECHNICAL DETAILS:

Removable cover: PARTIALLY	kg	m ³	mts
FLORIAN 1S	34	0.92	SOT DOWN 5.40/SOP UP 3.00
FLORIAN 2S	46	1.50	SOT DOWN 6.30/SOP UP 5.90
FLORIAN 3S	55	1.88	SOT DOWN 6.80/SOP UP 6.10