

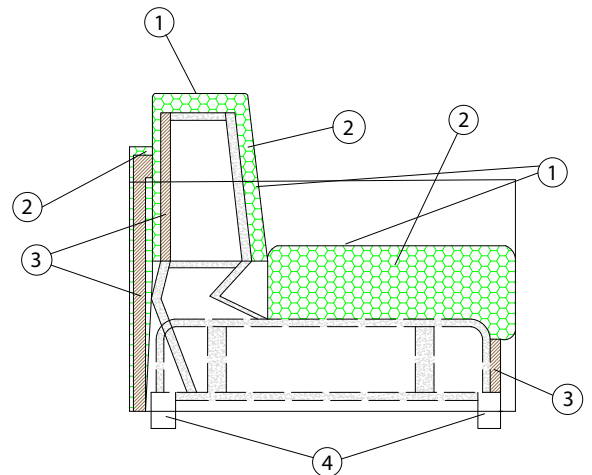

- 1 - dacron® fiber 100 gr;
- 2 - high resiliency polyurethane foam of different densities;
- 3 - structural frame in composite wood;
- 4 - wooden feet;
- 5 - elastic webbing.

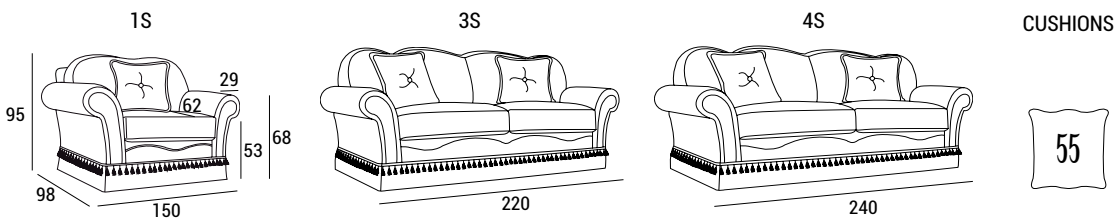

DIMENSIONS:



STANDARD BED:

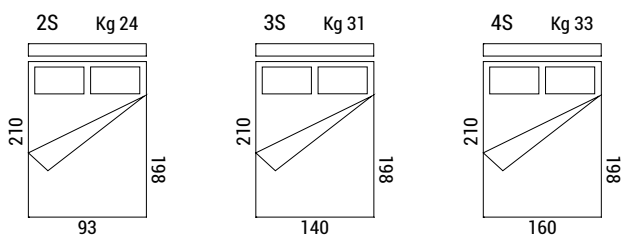

Fire retardant or standard polyurethane mattress, with two-fold mechanism, h 18 cm, covered with antiallergic polyester lining. High-resistance steel electrowelded mechanism

MECHANISM BED SOFA:

Opening



REMOVE
cable ties on the sides before
lifting the sleeping deck

Opening folding the bed
incorrectly could damage
the mechanism

Closing

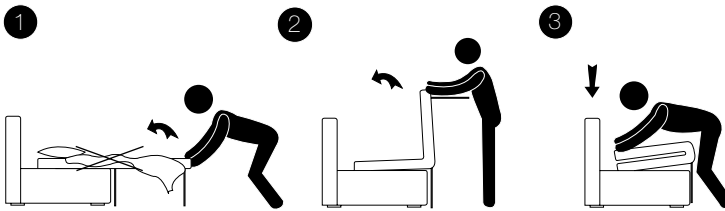

REMOVE
all sheet, blankets and pillows
before folding the sofa back up to
avoid breaking the mechanism

ELEKTRA VERSIONS:

fringe

flounce



MATCHING TRIMMINGS:

FANCY 1 OPTIONAL



TECHNICAL DETAILS:

Removable cover: PARTIALLY	kg	m ³	mts
ELEKTRA 1S	100	1.40	10.60
ELEKTRA 3S	115	2.05	14.45
ELEKTRA 4S	133	2.23	15.35